



# The City of Roanoke, VA

Parcel Id: 2520119

**Property Address:**

3321 SHENANDOAH AVE NW

ROANOKE, VA 24017



## SUMMARY:

**Mailing Address:**

PO BOX 13487

ROANOKE, VA 24034

**Neighborhood:** 600 - Shenandoah West

**Property Class:** 400-  
Commercial/Industrial

**Legal Description:** ACREAGE TROUT LANDS

**Zoning:** I-1

**Property Acreage:** 7.4090

**Property Sq. Footage:** 322736

**Property Frontage:** 607

**Property Depth:** 637.00

## FLOOD ZONE INFORMATION:

**Special Flood Hazard Area:**

**Firm Panel:** 51161C0161G

**Floodway:**

## OWNERSHIP HISTORY:

Sale Date	Sale Amount	Grantee	Grantor	Document Number
1990-02-14	\$153,300.00	L C M CORPORATION	MULTI CINEMA LTD (Inactive)	
1984-11-15	\$149,000.00	MULTI CINEMA LTD (Inactive)	TRINKLE BETTY F ETVIR (Inactive)	
N/A	\$0.00	TRINKLE BETTY F ETVIR (Inactive)		

## ASSESSMENTS:

Valuation Date	Land Value	Improvement Value	Total Value
2024-01-01	\$515,100.00	\$602,700.00	\$1,117,800.00
2023-01-01	\$515,100.00	\$602,700.00	\$1,117,800.00
2022-01-01	\$468,600.00	\$563,300.00	\$1,031,900.00

2021-01-01	\$426,000.00	\$563,300.00	\$989,300.00
2020-01-01	\$426,000.00	\$563,300.00	\$989,300.00

## RESIDENTIAL DWELLING DETAIL:

Primary Photo:

Primary Sketch:

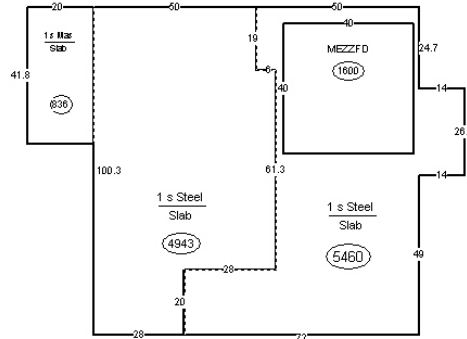

## IMPROVEMENTS:

IMPROVEMENT 1			
<b>1 Story</b>			
<b>Structure:</b>		<b>Roof:</b>	
Year Built:	1992	Roof Style:	2
Number of Stories:	1	Roof Cover:	
Construction Exterior:		<b>Plumbing:</b>	
Foundation:		2 Fixture:	
Structure:		3 Fixture:	
Size S/F:	11239	4 Fixture:	
Lower Split Level/Foyer:		5 Fixture:	
Lower Finished:		<b>Heating / Air:</b>	
Total Bedrooms:		Heating Type:	0 sf
Total Rooms:	0	Central Air:	N
<b>Attic:</b>		Fireplaces:	NO
Attic S/F:	None		

Attic Fin S/F:

**Porches:**

**Basement:**

Enclosed Porch:

Basement S/F:

Open Porch:

Basement Fin S/F:

Wood Deck:

**Other Improvements**

Mezzanine-Finished Divided

**Garage**

Attached Garage:

Detached Garage:

Attached Carport:

Basement Garage:

**PROPERTY MAP:**

---

