

**Property Location:** 2422 EASTLAND RD  
**Parcel ID:** 070.04-02-55.00-0000  
**Magisterial District:** Vinton  
**Account:** 26168  
**Card 1 of 1**

**Owner Name and Mailing Address:**  
 GILMORE TERRY L ; GILMORE REBECCA L  
 2522 HILL CIR ROANOKE VA 24014

**Current Property Assessment 2024**

**Total Building Value:** 82300  
**Total Land Value:** 38000  
**Total Value:** 122100



**Narrative Description**

This property contains 0.96000 AC of land with a(n) SINGLE FAMILY RESIDENCE style building, Built about 1955, having primary VINYL OR ALUMINUM exterior and ASPHALT / COMPOSITION SHINGLE roof cover, 3 bedroom(s), 1 full bath(s), 0 half bath(s).

**Property Characteristics**

**Jurisdiction:** Roanoke County  
**Legal Description:** S PT LT 2 SEC 25 RIVERDALE FARM  
**Deeded Acreage:** 0.96000 AC      **Neighborhood:** B012 / EASTLAND RD / HILL DR  
**Estimated Acreage:** 0.9322 AC      **Census Block:** 511610310001005  
**Vacant Land:** NO      **Land Use Program:** NO

**Sales Information  
Most Recent Sales**

<u>Sale Date</u>	<u>Sale Price</u>	<u>Legal Reference</u>
12/14/1992	52500	DB0013870988
8/1/1991	45000	DB0013480672
1/1/1900	0	PB0134800675
1/1/1900	0	DB0011120277

**Property Location:** 2422 EASTLAND RD  
**Parcel ID:** 070.04-02-55.00-0000  
**Magisterial District:** Vinton  
**Account:** 26168  
**Card 1 of 1**

**Zoning Information**

**Split:**

Zoning Code  
County-AR

Zoning Description  
[Agricultural/ Residential](#)

Action No:  
Date:  
Ordinance:  
Name:



**Property Location:** 2422 EASTLAND RD  
**Parcel ID:** 070.04-02-55.00-0000  
**Magisterial District:** Vinton  
**Account:** 26168  
**Card 1 of 1**

**Overlay Districts**

<b>Emergency Communications:</b> <a href="#">No</a>	<b>Roanoke River Conservation:</b> <a href="#">No</a>
<b>Airport:</b> <a href="#">No</a>	<b>*Manufactured Housing:</b> <a href="#">No</a>
<b>Wellhead Protection:</b> <a href="#">Yes</a>	<b>Clearbrook Village:</b> <a href="#">No</a>
<b>Floodplain:</b> <a href="#">No</a>	

\*For more Information on Roanoke County Zoning, please call 540-772-2068 or visit <https://www.roanokecountyva.gov/pz>

**Community Number:** 510190

**Flood Zone Information**

**Flood Certificates**    **FIRM Panel:** [51161C0169G](#)  
**Flood Zone:** X

**Effective Date:** 9/28/2007  
**Floodway:**

**Building Description**

<b>Building Type:</b> SINGLE FAMILY RESIDENCE	<b>Foundation Type:</b> CONTINUOUS FOOTING
<b>Year Built:</b> 1955	<b>Roof Structure:</b> GABLE
<b>Finished Area (SF):</b> 1052	<b>Roof Cover:</b> ASPHALT / COMPOSITION SHINGLE
<b>Style/Story Height:</b> RANCH WITH BASEMENT	<b>Primary Exterior Wall:</b> VINYL OR ALUMINUM
<b>Bedrooms:</b> 3	<b>Secondary Exterior Wall:</b>
<b>Full Baths:</b> 1	<b>Primary Interior Walls:</b> DRYWALL
<b>Half Baths:</b> 0	<b>Secondary Interior Wall:</b>
<b>Air Conditioning:</b>	<b>Primary Floors:</b> CARPET
<b>Heating:</b> 100%	<b>Secondary Floors:</b>
<b>Heating Type:</b> AIR-DUCTED	<b>Basement Garage:</b>
<b>Heating Fuel:</b> ELECTRIC	<b>Fireplace:</b> 1 FIREPLACE

**Property Location:** 2422 EASTLAND RD  
**Parcel ID:** 070.04-02-55.00-0000  
**Magisterial District:** Vinton  
**Account:** 26168  
**Card 1 of 1**

**Building Areas**

<u>Sub Area</u>	<u>Sketched Area</u>	<u>Finished Area</u>	<u>Perimeter</u>
BASE	1052	1052	136
BSMT - UNFIN	775	0	0
PRCH-OPEN UN	32	0	24
WOOD DECK	295	0	98

**Property Location:** 2422 EASTLAND RD

**Parcel ID:** 070.04-02-55.00-0000

**Magisterial District:** Vinton

**Account:** 26168

**Card 1 of 1**

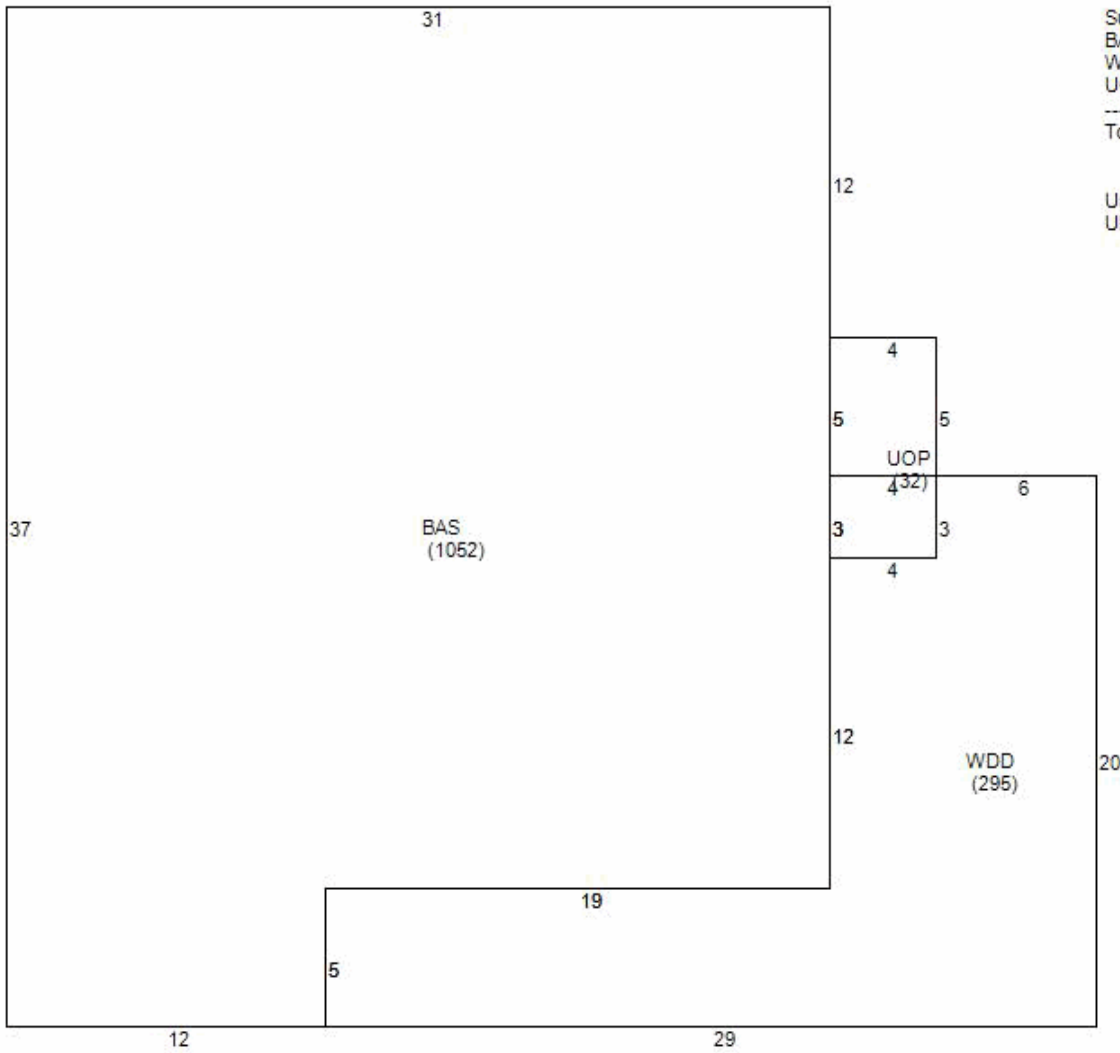

Sum Area by Label:  
 BAS=1052 (ADJ=1052)  
 WDD=295 (ADJ=295)  
 UOP=32 (ADJ=32)  
 -----  
 TotArea:1379 TotAdjArea: 1379

UnSketched Subareas:  
 UBM (775)

---

**Property Location:** 2422 EASTLAND RD  
**Parcel ID:** 070.04-02-55.00-0000  
**Magisterial District:** Vinton  
**Account:** 26168  
**Card 1 of 1**

---

### Services

**Trash Service:** [Monday](#)

[Website](#)

**Bulk & Brush Pickup:** [B Route](#)

**Services:**

**Recycling:** [Map](#)

Transfer Station Hollins Road (3.09 miles)

**Recreational Center:** [Map](#)

Craig Avenue Recreation Center (1.51 miles)

**Library:** [Map](#)

Mount Pleasant Branch Library (1.56 miles)

**Police Station:** [Map](#)

[Public Safety Center, 5925 Cove Rd, Roanoke VA](#)

**Fire Station:**

[Mount Pleasant](#)

---

### Schools

**Elementary School:** [Mount Pleasant](#)

**Middle School:** [William Byrd](#)

**High School:** [William Byrd](#)

**Property Location:** 2422 EASTLAND RD  
**Parcel ID:** 070.04-02-55.00-0000  
**Magisterial District:** Vinton  
**Account:** 26168  
**Card 1 of 1**

**Broadband Providers**

**Satellite**

<u>Provider Name</u>	<u>Upload Speed</u>	<u>Download Speed</u>
HUGHESNET	Data Not Available	Data Not Available
DISHNET SATELLITE BROADBAND	Data Not Available	Data Not Available
SKYCASTERS	Data Not Available	Data Not Available
VIASAT INC	Data Not Available	Data Not Available

**Wireless 4G**

<u>Provider Name</u>	<u>Upload Speed</u>	<u>Download Speed</u>
AT&T MOBILITY	Data Not Available	Data Not Available
NTELOS	Data Not Available	Data Not Available
T-MOBILE	Data Not Available	Data Not Available
US CELLULAR	Data Not Available	Data Not Available
VERIZON WIRELESS	Data Not Available	Data Not Available

**Wireless LTE**

<u>Provider Name</u>	<u>Upload Speed</u>	<u>Download Speed</u>
AT&T MOBILITY	Data Not Available	Data Not Available
T-MOBILE	Data Not Available	Data Not Available
US CELLULAR	Data Not Available	Data Not Available
VERIZON WIRELESS	Data Not Available	Data Not Available

**Wireline Cable**

<u>Provider Name</u>	<u>Upload Speed</u>	<u>Download Speed</u>
COX COMMUNICATIONS	Data Not Available	Data Not Available

**Property Location:** 2422 EASTLAND RD

**Parcel ID:** 070.04-02-55.00-0000

**Magisterial District:** Vinton

**Account:** 26168

**Card 1 of 1**

**Wireline DSL**

Provider Name

Upload Speed

Download Speed

VERIZON VIRGINIA LLC

Data Not Available

Data Not Available



**Property Location:** 2422 EASTLAND RD  
**Parcel ID:** 070.04-02-55.00-0000  
**Magisterial District:** Vinton  
**Account:** 26168  
**Card 1 of 1**

**Pictometry**



**Tax Map**



**Property Location:** 2422 EASTLAND RD

**Parcel ID:** 070.04-02-55.00-0000

**Magisterial District:** Vinton

**Account:** 26168

**Card 1 of 1**

**Hybrid**

